

19 Install standard interior doors. (For exterior door see next page.)

- (a) Attach header board.
- (b) Attach side jamb boards.
- (c) Slide pre-hung door into position and center in jamb. Fasten door through pre-hung door jamb into sliding jambs on both sides.
- (d) Fasten trim pieces as shown on inside and outside of door openings.
- (e) Install door latch using instructions supplied with latch.

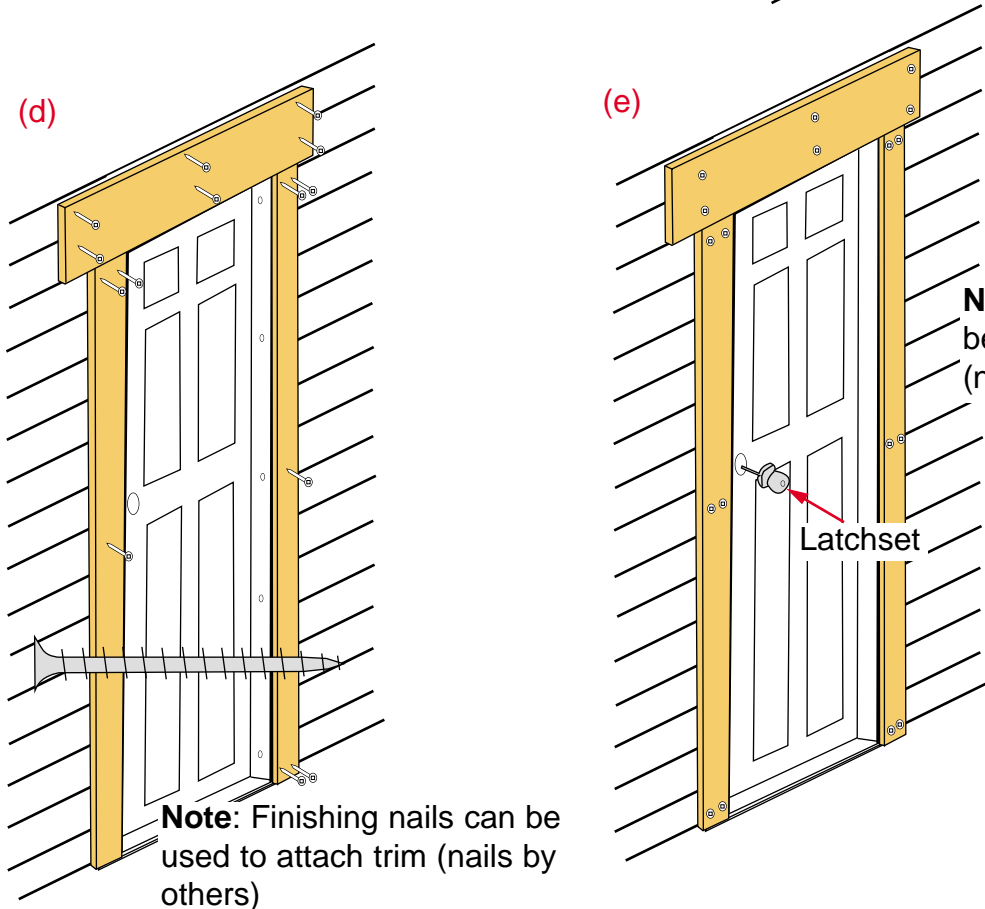
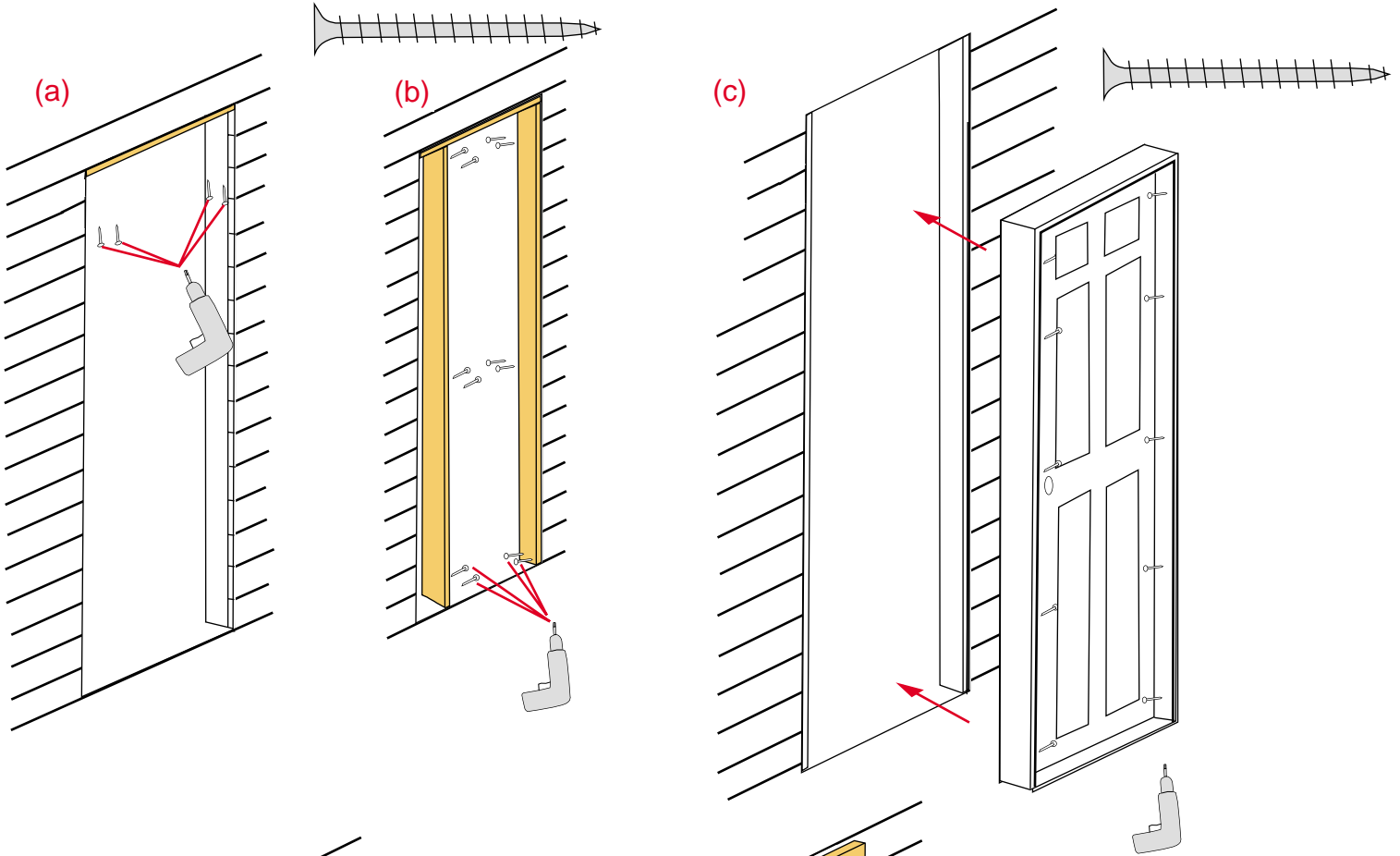

Note: Finishing nails can be used to attach trim (nails by others)

Note: Finishing nails can be used to attach trim (nails by others)